

NEWS FROM **SIDWELL**

PROVIDER OF AERIAL PHOTOGRAPHY, MAPPING SERVICES AND GEOGRAPHIC INFORMATION SYSTEMS

Ground Breaking Held for Building Construction

A ground breaking ceremony was held on December 15, 1998, to formally recognize the start of construction of a new headquarters building for Sidwell.

During the event company officials, along with representatives of the project management, architectural and construction team, were present at the construction site located on the east side of St. Charles, Ill.

According to Sidwell President and CEO Timothy C. Hopkins, "The facility to be built has been specifically designed to meet the technical needs of the company. We view this move as the next logical step in the organization's ongoing technical evolution as one of the preeminent companies in the GIS [geographic information systems] market."

Plans to develop the new facility call for the construction of a precast concrete structure comprising approximately 27,000 square feet of space to house administrative offices, GIS compilation operations and other functions, including a customer service area to accommodate sales of maps and related products. The parking lot at the site will have the capacity to accommodate 100 cars. Full occupancy of the facility, which will bear the address of 675 Sidwell Court, St. Charles, IL 60174, is expected in the summer of 1999.



Members of Sidwell's management team at the recent ground breaking ceremony. Pictured left to right: Vice President of Operations Neal Carpenter, Director of Photogrammetry Gary Lobdell, Director of Corporate Information Systems David Larson, and President and CEO Timothy C. Hopkins.

"We anticipate that this new building will afford greater efficiencies in operations and workflow, and improvements in our ability to communicate—through new phone system and electronic data transfer capabilities—contributing to better delivery methods and greater responsiveness," says Sidwell Vice President of Operations Neal Carpenter. "We are in the business of providing quality products and services to meet client needs, and this building will enhance our ability to do that in the 21st Century," he concludes.



An architectural rendering of the building to be completed for occupancy this summer. The architect for the project is Hammel, Green and Abrahamson, Inc., Milwaukee.

Users Conferences Scheduled for Spring

The 1999 conferences for users of Sidwell systems are scheduled to be held April 20th at the Holiday Inn-Bloomington/Normal, in Normal, Ill., and April 28th, at the Holiday Inn Airport in Des Moines.

Sidwell's 17th annual users conferences will feature two conference tracks comprising seven different sessions; and representatives of Environmental Systems Research Institute Inc. (ESRI) are scheduled to participate in the program.

Individuals who are not currently users of Sidwell systems, but who would like to learn about the company and its services, are invited to attend either event, space permitting. To request registration information for either of these events, please e-mail mhamilton@sidwellco.com, or phone (630) 231-0206.

Sidwell Awarded Contracts to Perform Services

Sidwell was awarded a contract by **Porter County, Ind.**, to perform GIS development and implementation services. The contract calls for Sidwell to secure aerial photography of the county and subsequently develop digital orthophoto imagery; develop a digital cadastral map database; install computer hardware and GIS software; and provide training services.

Sidwell has received a contract from **Washington County, Ill.**, to perform digital cadastral mapping, soil survey conversion, and the implementation of Sidwell's *Farmland Assessment and Report Management System* (FARMS), a GIS software application designed to support conversion and maintenance of digital map layers for use in assessing agricultural land parcels.

The project calls for the acquisition of new aerial photography, the production of digital orthophotos, conversion of rural cadastral maps to a digital format, soil survey conversion, preparation of the map databases for acreage computations on agricultural parcels, FARMS software, and training.

FARMS can be used to generate reports detailing computed valuations based on soil types and acreage, as well as to create thematic maps portraying soil types, land use, productivity indexes or valuation. The system relies on Bentley Systems, Inc. MicroStation GeoGraphics® software to create topology.

1999 Users Conferences At a Glance

Registration begins at 8:00 a.m. Opening comments and introductions begin at 8:30 a.m.

Sessions run from 9:00 a.m. to 4:15 p.m., with the following breaks: 10:15 a.m. - 10:30 a.m.; noon - 1:00 p.m. (lunch); 2:30 p.m. - 2:45 p.m.

SESSION AGENDA

Track I: Geographic Information Systems

ABCs of GIS (75 minutes)

Mapping in the Office: Back to Basics (90 minutes)

Sidwell Parcel Maintenance Tools...in ARC/INFO (90 minutes)

Turning Your Parcel Maps into Smart, GIS-Ready Maps (90 minutes)

Track II: Cadastral Mapping Workshops

Digital Orthophotography: The Base Map of Choice for GIS (75 Minutes)

Introduction to Sidwell Maps (90 minutes)

Legal Descriptions - A to Z (180 minutes - comprises two afternoon sessions)

Sidwell has also been awarded a contract by **Douglas County, Ill.**, to perform GIS development and implementation services. Sidwell is to create for the county a GIS containing digital orthophotography, and cadastral map data for use in a Bentley MicroStation® software environment. The project will involve securing aerial photography of the county; performing analytic aerial triangulation to supplement a basic horizontal control network; developing the digital orthophoto imagery; and cadastral mapping using land records for reference. Additionally, Sidwell, is to perform acreage computations for agricultural parcels and to implement FARMS software.

Also, Sidwell was awarded a contract by **Crawford County, Ill.**, to secure aerial photography of the county and subsequently develop digital orthophotography; and, the company received a contract from the **Village of Mt. Prospect, Ill.**, to perform GIS development services, including verification of data in an existing cadastral map database representing approximately 15,000 real estate parcels, and conversion of the parcel base map for use in an ESRI® ARC/INFO® GIS software environment.

Bentley, MicroStation and MicroStation GeoGraphics are registered trademarks of Bentley Systems, Inc. ESRI and ARC/INFO are registered trademarks of Environmental Systems Research Institute Inc.

The Tech Desk

This column is provided by Sidwell's Project Management Department to present useful information about mapping techniques, GIS applications and related topics.

Alphabet Soup

Technology can intimidate users because it often shrouds a lot of good ideas and common sense in confusing lingo. Worst of all, it seems, are the acronyms; and perhaps no industry is more guilty of their over use than the computer industry. When you strip away the curtain, acronyms often reveal themselves as simple, and even silly, concepts. Often but not always. Defined here are some of the stranger and/or more important acronyms you are likely to run into in your use of GIS and computers.

- **GUI** ("Gooley") - Short for "graphical user interface." The on-screen boxes, buttons and menus used to run Microsoft Windows® on a PC are a GUI. If you're using DOS, you're using a command-line interface instead of a GUI.
- **WYSIWYG** ("Wiz-ee-wig") - Short for "what you see is what you get," and is often used when printing something.
- **WYPIWYG** ("Wip-ee-wig") - "What you push is what you get." This one's used with digitizers.
- **TWAIN** ("Twain," as in Mark) - One of the sillier acronyms, it stands for "technology without an interesting name." This one is associated with scanners and scanning technology.
- **CAD** ("Cad," as in Snidely Whiplash) - refers to "computer-aided design" or "computer-aided dispatch," depending on who you're talking to.
- **ODBC** ("Oh-Dee-Bee-See") - Stands for "open database connectivity." This is an industry standard for passing data from one application to another, and is very important in GIS.
- **SQL** ("Sequel") - "Structured query language." An intuitive language for managing many different databases and their contents.

DeHainaut to Speak at Industry Conference

Sidwell Director of Project Management Scott DeHainaut is scheduled to speak on April 13th in New Orleans, at the 1999 *Integrating GIS & CAMA Conference* sponsored jointly by the International Association of Assessing Officers and the Urban and Regional Information Association. Scott's presentation, titled "Farmland Assessment and GIS: A Thematic Approach to Mass Appraisal," will explore GIS as an analysis and mass appraisal tool.

In his presentation Scott will review basic GIS concepts such as control, coordinate systems and accuracy, and will describe their impact on the mapping of parcels, soil types and land use. The presentation will explore how these three distinct thematic layers, and the attribute data associated with them, can be integrated to determine soil type and land use content for individual parcels. Using a variety of commercial GIS and CAD applications, Scott will demonstrate a number of approaches to determine the mass value of large rural regions.



S. DeHainaut

Sidwell Recognized for Technical Support

Sidwell was included among a group of MicroStation Value-Added Resellers/Partners nominated for recognition in Bentley Systems Inc.'s 1998 Proactive Engineering Success (PES) Awards, which were presented last October 16th at Bentley's 1998 Proactive Engineering Symposium in Philadelphia. Sidwell, which was one of only 20 companies identified as having been nominated in the *Best Technology Support* category of the prestigious, international competition, was recognized with an honorable mention.

The PES Awards, according to the Exton, Pa.-based engineering software company, "were created to honor organizations that have harnessed the power of the Bentley Continuum™ through the ongoing use of Bentley products." The *Best Technology Support* category, states Bentley, "honors excellence in world-class support, products and service to users of Bentley products." According to PES Awards Program Manager Lisa Smith, Sidwell received an honorable mention in the category for "its proactive and innovative employment of Bentley technology, and its outstanding technical support of Bentley products."

THE SIDWELL COMPANY
28W240 North Avenue
P. O. Box 920
West Chicago, IL 60186-0920

BULK RATE
U. S. POSTAGE
PAID
CAROL STREAM, IL
PERMIT NO. 475

Conference Calendar

Sidwell 1999 Users Conferences

April 20, 1999, Holiday Inn-
Bloomington/Normal, Normal, Ill.

April 28, 1999, Holiday Inn Airport,
Des Moines, Iowa.

See page 2 for more information.

**Look for a Sidwell representative at
the company's exhibit on the
following dates at these upcoming
events:**

March 17-19, 1999, Iowa State
Association of Counties 1999 Spring
School of Instruction, Des Moines.

April 25-26, 1999, Illinois Association
of County Officials Spring
Conference, Peoria.

May 19-20, 1999, 1999 Public Works
Week Conference and Trade
Exposition, Villa Park, Ill.

Considering a GIS?

The Sidwell Company
can create a geographic
information system (GIS)
to assist in the
administration of a
variety of local
government operations.

Mapping and digital
orthophoto development
are among a range of
services Sidwell offers to support the implementation of GIS
solutions. For more information, contact:

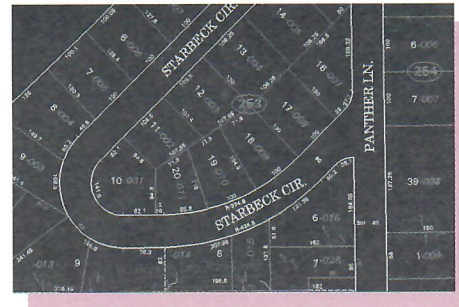

THE SIDWELL COMPANY

28W240 North Ave., P. O. Box 920
West Chicago, IL 60186-0920
(630) 231-0206; FAX (630) 231-8206
<http://www.sidwellco.com>